



YARD DUTY AND SUPERVISION POLICY

PURPOSE

To ensure school staff understand their supervision and yard duty responsibilities.

SCOPE

This policy applies to all teaching and non-teaching staff at Quarry Hill Primary School, including education support staff, casual relief teachers and visiting teachers.

POLICY

Appropriate supervision is an important strategy to monitor student behaviour and enables staff to identify and respond to possible risks at school as they arise. It also plays a vital role in helping schools to discharge their duty of care to students.

The Principal is responsible for ensuring that there is a well organised and responsive system of supervision and yard duty in place during school hours, before and after school, and on school excursions and camps and other school activities.

School staff are responsible for following reasonable and lawful instructions from the Principal, including instructions to provide supervision to students at specific dates, times and places.

Before and after school

Quarry Hill Primary School's grounds are supervised by school staff from 8.45am until 3.40pm. Outside of these hours, school staff will not be available to supervise students. Parents will be reminded each term through the newsletter.

Before and after school, school staff will supervise the school basketball court, junior astro turf and Peel Street entrance of the school.

Parents and carers should not allow their children to attend Quarry Hill Primary School outside of these hours. Families are encouraged to refer to www.campaustralia.com.au for more information about the before and after school care facilities available to our school community.

If a student arrives at school before supervision commences at the beginning of the day, the Principal or nominee staff member will, as soon as practicable, follow up with the parent/carer to:

- advise of the supervision arrangements before school
- request that the parent/carer make alternate arrangements.

If a student is not collected before supervision finishes at the end of the day, the Principal or nominee staff member will consider whether it is appropriate to:

- attempt to contact the parents/carers
- attempt to contact the emergency contacts
- place the student in an out of school hours care program (if available and the parent consents)
- contact Victoria Police and/or Child Protection to arrange for the supervision, care and protection of the student.

Yard duty zones

All staff at Quarry Hill Primary School are expected to assist with yard duty supervision and will be included in the weekly roster.

The principal or Assistant Principal is responsible for preparing and communicating the yard duty roster on a regular basis. At Quarry Hill school staff will be designated a specific yard duty area to supervise.

The designated yard duty areas for our school (as at Term 1, 2021) are:

Zone	Area
Zone 1	Senior astro turf and asphalt
Zone 2	Rock climbing wall, senior playground and junior playground
Zone 3	Junior playground and quadrangle

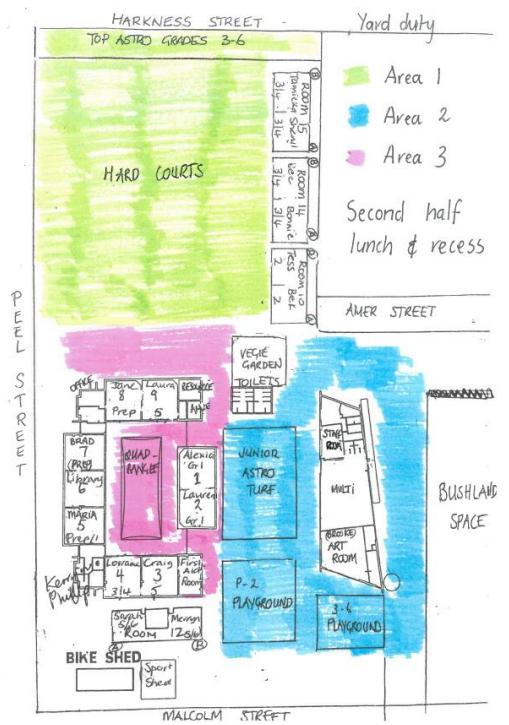

Yard duty equipment

School staff must:

- Wear a provided safety/hi-vis vest whilst on yard duty. Each staff member has been provided with their own vest. Safety/hi-vis vests for casual replacement teachers will be stored in the first aid room.
- Carry the yard duty first aid bag at all times during supervision. The yard duty first aid bag will be stored in the first aid room

Yard duty equipment must be returned after the period of supervision or handed to the relieving staff member.

Yard duty responsibilities

Staff who are rostered for yard duty must remain in the designated area until they are replaced by a relieving staff member.

During yard duty, supervising school staff must:

- methodically move around the designated zone
- be alert and vigilant
- intervene immediately if potentially dangerous or inappropriate behaviour is observed in the yard

- enforce school wide expectations and implement appropriate consequences for breaches of safety rules, in accordance with any relevant disciplinary measures set out in our *Student Engagement and Wellbeing* policy
- ensure that students who require first aid assistance receive it as soon as practicable
- log any incidents or near misses as appropriate [i.e. on Compass]

if being relieved of their yard duty shift by another staff member (for example, where the shift is 'split' into 2 consecutive time periods), ensure that a brief but adequate verbal 'handover' is given to the next staff member in relation to any issues which may have arisen during the first shift.

If the supervising staff member is unable to conduct yard duty at the designated time, they should contact the Assistant Principal with as much notice as possible prior to the relevant yard duty shift to ensure that alternative arrangements are made.

If the supervising staff member needs to leave yard duty during the allocated time, they should contact the Assistant Principal but should not leave the designated area until the relieving staff member has arrived in the designated area.

If the relieving staff member does not arrive for yard duty, the staff member currently on duty should send a message to the office and not leave the designated area until a relieving staff member has arrived.

Students will be encouraged to speak to the supervising yard duty staff member if they require assistance during recess or lunchtime.

Classroom

The classroom teacher is responsible for the supervision of all students in their care during class.

If a teacher needs to leave the classroom unattended at any time during a lesson, they should first contact the front office for assistance. The teacher should then wait until another staff member has arrived at the classroom to supervise the class prior to leaving. If it is a matter of urgency they need to take their class in to a neighbouring classroom.

School activities, camps and excursions

The Principal and leadership team are responsible for ensuring that students are appropriately supervised during all school activities, camps and excursions, including when external providers are engaged to conduct part or all of the activity. Appropriate supervision will be planned for school activities, camps and excursions on an individual basis, depending on the activities to be undertaken and the level of potential risk involved.

Digital devices and virtual classroom

Quarry Hill Primary School follows the Department's [Cybersafety and Responsible Use of Technologies Policy](#) with respect to supervision of students using digital devices.

Quarry Hill Primary School will also ensure appropriate supervision of students participating in remote and flexible learning environments while on school site. In these cases, students will be supervised in the designated learning space. While parents are responsible for the appropriate supervision of students accessing virtual classrooms from home:

- student attendance will be monitored daily.

- any wellbeing or safety concerns for the student will be managed in accordance with our usual processes – refer to our Student Wellbeing and Engagement Policy and our Child Safety Responding and Reporting Policy and Procedures for further information.

Students requiring additional supervision support

Sometimes students will require additional supervision, such as students with disability or other additional needs. In these cases, the Principal or delegate will ensure arrangements are made in the roster.

Supervision of student in emergency operating environments

In emergency circumstances our school will follow our Emergency Management Plan, including with respect to supervision.

In the event of any mandatory period of remote or flexible learning our School will follow the operations guidance issued by the Department.

Bushland supervision

Teachers are rostered on the yard duty timetable to supervise the bushland space. An announcement will be made notifying the students when the bushland is open for play. Until the duty teacher arrives students are required to line up and wait.

When students are working in the bushland during class time they will be supervised by the class teacher.

COMMUNICATION

This policy will be communicated to our school community in the following ways:

- Included in staff induction processes
- Discussed at staff briefings or meetings, as required
- Included in our staff handbook
- Included as a reference in our school newsletter each term.

Information for parents and students on supervision before and after school is available on our school website and parent reminders are sent at the beginning of each term in our school newsletter.

FURTHER INFORMATION AND RESOURCES

- the Department's Policy and Advisory Library (PAL):
 - [Child Safe Standards](#)
 - [Cybersafety and Responsible Use of Technologies](#)
 - [Duty of Care](#)
 - [Excursions](#)
 - [Supervision of Students](#)
 - [Visitors in Schools](#)

POLICY REVIEW AND APPROVAL

Policy last reviewed	Term 1 2021
Approved by	Principal
Next scheduled review date	Term 1 2022

This policy will also be updated if significant changes are made to school grounds that require a revision of Quarry Hill Primary School's yard duty and supervision arrangements.